

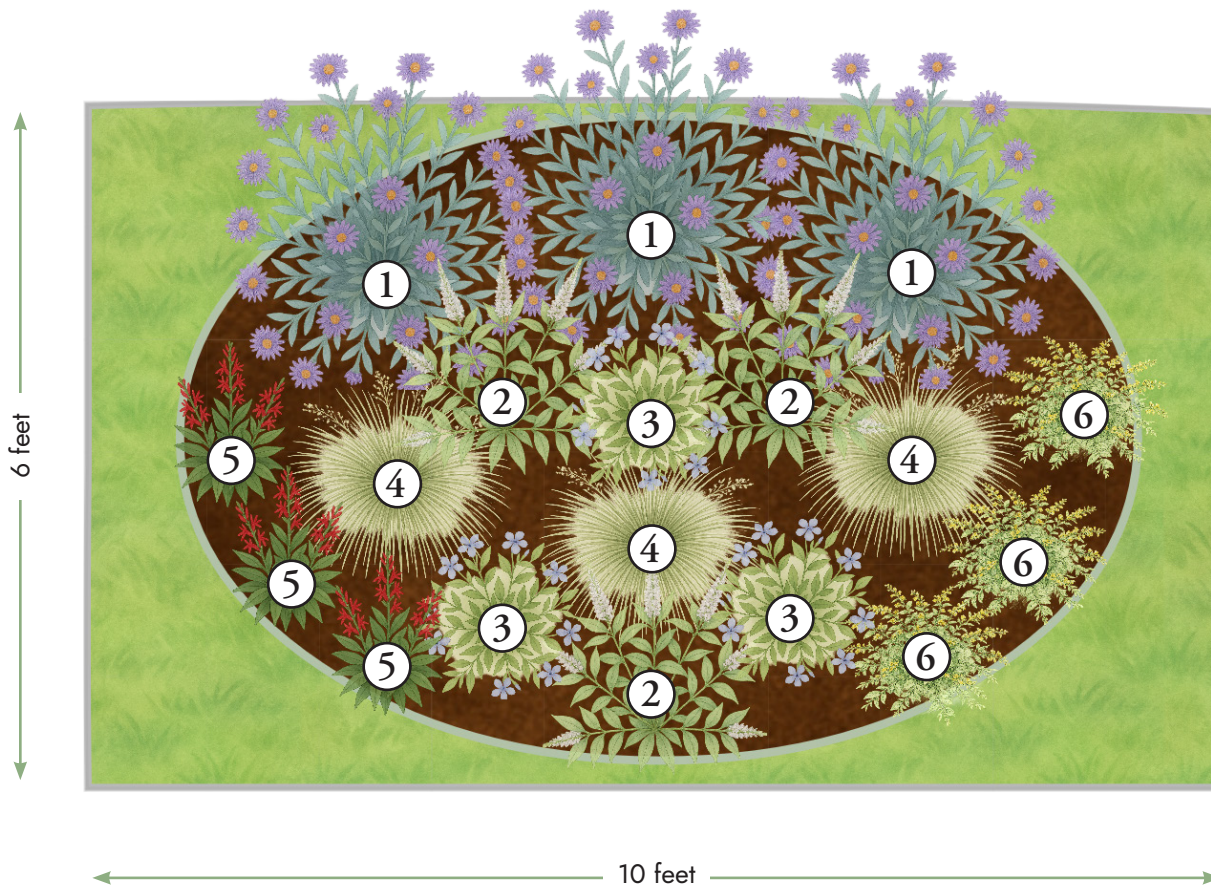

# MOONLIGHT FIREFLY GARDEN

## Native Garden Kit Design



- ① Aster, New England (*Symphotrichum novae-angliae*)  
3 plants, 2-foot spacing
- ② Culvers Root (*Veronicastrum virginicum*)  
3 plants, 2-foot spacing
- ③ Woodland Phlox (*Phlox divaricata*)  
3 plants, 1.5-foot spacing
- ④ Prairie Dropseed (*Sporobolus heterolepis*)  
3 plants, 2-foot spacing
- ⑤ Cardinal Flower (*Lobelia cardinalis*)  
3 plants, 1-foot spacing
- ⑥ Zig-Zag Goldenrod (*Solidago flexicaulis*)  
3 plants, 1.5-foot spacing

**Suggested add-ons:**\* Obedient Plant (*Physostegia virginiana*), Side-oats Grama (*Bouteloua curtipendula*), Straight-styled Wood Sedge (*Carex radiata*), Foamflower (*Tiarella cordifolia*), and Little Bluestem (*Schizachyrium scoparium*).

\*Not included in kit. Individual plants can be purchased at our in-person sale.

**Notes:** Create a firefly-friendly garden by planting in a moist, part-shade area that retains humidity. Leave fallen leaves that firefly larvae need. Avoid pesticides, and reduce light pollution by turning off outdoor lighting at night to support firefly mating.